

AIR^{OPUS}

TENT INFLATION TECHNOLOGY

FORWARD FOLD OWNERS HANDBOOK

2 SLEEPER



PCT Patent Pending GB/2017/050391 &
Australian Patent Pending 2017902549
Design registration No 201712810, No
201712811, No 201712812, No 201712813



GOOD
DESIGN
Award



GERMAN
DESIGN
AWARD
WINNER
2018

opuscamper.com.au

PCT Patent Pending GB/2017/050391 &
Australian Patent Pending 2017902549
Design registration No 201712810,
No 201712811, No 201712812,
No 201712813

Vehicle Identification Number (VIN)	Page 2
Specifications	Page 3 - 4
Dimensions	Page 5
11 Quick Tips to set up your Air OPUS®	Page 6 - 7
Hitching & Trailer Electrics	Page 8
Air OPUS® Brake Set Up	Page 9
Setting Up your Air OPUS® Camper	Page 10 - 11
Understanding the Air OPUS® Switchboard	Page 12
Understanding the air valves when setting up your Air OPUS® Camper	Page 13
Air OPUS® Water System	Page 14 -15
Air OPUS® Gas System	Page 16
Air OPUS® 240 Volt Mains Power	Page 17
Air OPUS® 12 Volt Power	Page 18
Air OPUS® Fridge Slide	Page 19
Setting up the Additional Day Bed	Page 20
Installing your Air OPUS® Annexe	Page 21 - 23
Installing your Air OPUS® Ensuite	Page 24
Air OPUS® Care & Maintenance	Page 25 - 30
Air OPUS® Warranty	Page 31 - 33

PCT Patent Pending GB/2017/050391 & Australian Patent Pending 2017902549
 Design registration No 201712810, No 201712811, No 201712812, No 201712813

VEHICLE IDENTIFICATION NUMBER (VIN)

About your Vehicle Identification Number

Every Air OPUS® has a Vehicle Identification Number (VIN). The VIN Plate can be found on the exterior of your Air OPUS® to the left of the door secured, to the draw bar. We recommend making a note of your VIN in the template below. This will be required by insurance companies.

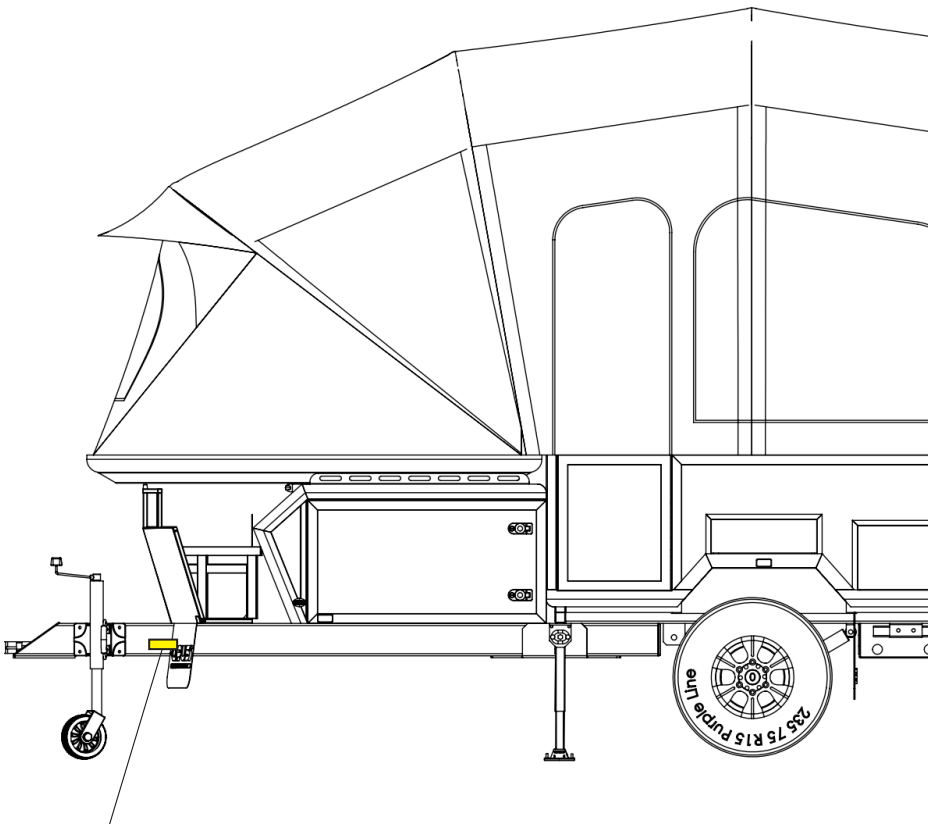

MANUFACTURER: PURPLE LINE PTY LTD

TRAILER MODEL: OPUS / PART #

DATE OF MANUFACTURE:

AGGREGATE TRAILER MASS:

VIN:

This trailer was manufactured to comply with the motor vehicle standards act 1989

RECOMMENDED COLD INFLATION PRESSURE AT:

TARE:

MAXIMUM LOAD: kPa

TYRE SIZE:

AXLE LOAD CAPACITY: Kg

WHEEL RIM SIZE/PROFILE:

The tyres fitted to this vehicle shall have a speed category at least equal to the recommended maximum vehicle operating speed km/hr

OPUS® Camper Trailers: 12 Capital Court Braeside
Victoria 3195. For more information contact us on
Ph: 03 9588 2959 enquiries@opuscamper.com.au

OPUS®
OPUSCAMPER.COM.AU

SPECIFICATIONS - 2 SLEEPER

Body Work	Baked enamel finish
Box Material	Main body aluminium frame & composite panel exterior, with galvanized steel chassis and draw bar
Dimension (Lid Closed)	5600 x 1950 x 1550
Dimension (Lid Open)	6950 x 1950 x 3470
Ground clearance	490mm
Ride Height	1550mm
Chassis	500 x 1870 x 720mm
Drawbar	2600 x 1390 x 150mm
King Size Bed	1900 x 1600

Features

Coupling	Articulating Poly block
Suspension	Independent Coil Spring Suspension
Shock Absorber	Quad Shock: Dual Gas Shock Absorber per side
Kitchen	Fully Stainless Steel Kitchen with 4 burner stove & sink with electric tap with slide out extension
Water System	2 x Electric Water Pump
Water Tank	2 x Stainless Steel Tanks (1 x 35L, 1 x 85L)
Water Tank Guard	1.5mm checker plate
Fridge Tray	1070L x 540W x 500H
Stabiliser Legs	4 x Drop down lockable
Jockey Wheel	Adjustable height swing up
Jerry Can Holders	2 x 20L
Gas Bottle Holders	Twin 9kg adjustable gas rings
Stone Guard	Front Surface coated with anti chip deadener
Wheels & Tyres	15" Alloy Wheels 235/75R15 All Terrain Tyres
Spare Wheel	15" Alloy 235/75R15 All Terrain Tyre
Brake System	12" Electric brakes with hand brake
Lights	LED
Portable Toilet	Standard
External Shower	Cold water supplied from tank

SPECIFICATIONS - 2 SLEEPER

Electrical

Power Supply	12V & 240V
Towing	7 PIN flat plug & Anderson plug
Stereo System	Stereo System with 2x speakers, Radio, USB inputs, CD & DVD player
Battery	2x 100Ah deep cycle AGM batteries with 240V charger
Trailer Lights	LED tail lights, clearance lights, internal lights, number plate light, tool box lights, kitchen light, annexe light

Tent/Canopy

Material	340g Micro Weave Poly Cotton
Tropical Roof	Waterproof and UV Protective Tropical Roof
Annexe	Fully Enclosed Annexe with removable doors & side walls
Awning	Annexe with doors & end walls removed
Ensuite Room	Removable ensuite with floor

Optional Accessories

Foldable Roof Rack	+80kg tare weight (200kg load capacity)
e-Go Movers	Remote controlled
LED Light Kit	Flexible Strip lighting system



DIMENSIONS - 2 SLEEPER

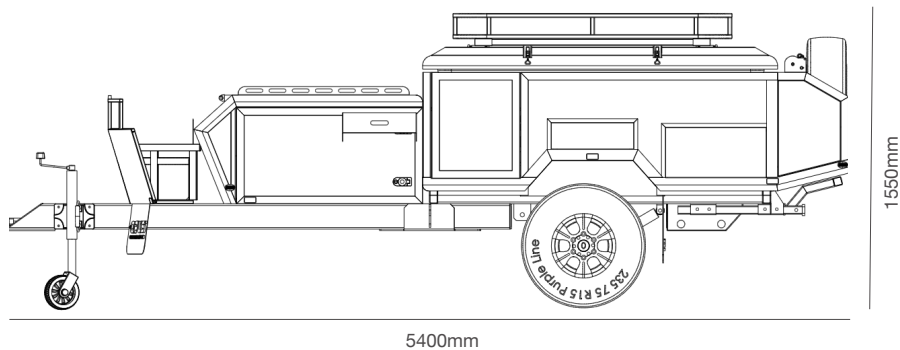
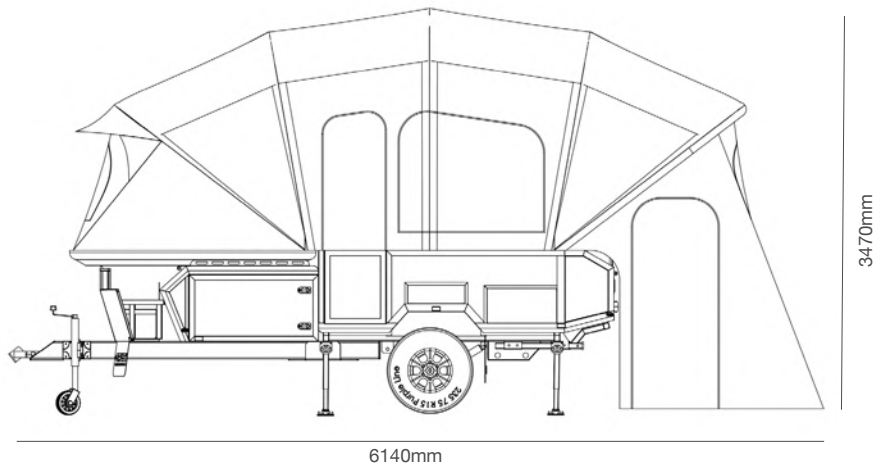
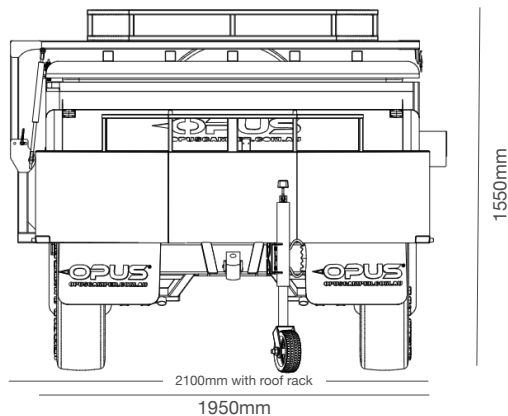

11 Quick Tips to set up and pack up your Air OPUS®

Tip 1 - Invest in a cordless drill and 19mm hex head bit to adjust stabiliser legs rather than manually winding them.



Tip 4 - When operating the winches ensure that the winch strap remains flat when using or retracting.

Tip 2 - To avoid placing too much pressure on the latches and breaking the latch hook, make sure you latch down the back of the camper first (furthest from the hinge).



Tip 3 - You can adjust the latch by turning it along the thread, thus extending it to avoid excessive pressure on the latches. You can close your camper with the latches longer, and then return to tighten these up.



Tip 5 - Take special care to ensure all canvas is tucked away on all sides especially around gas struts, hinge points.



Tip 6 - When using your key to open and unlock the door, push the door inwards on the seal to take pressure off the lock and it will open easier for you.

11 Quick Tips to set up and pack up your Air OPUS®

Tip 7 - During canopy inflation make sure all external air valves are closed off and the main air valve is open before turning air pump on.

Tip 8 - During annexe inflation make sure the air valves are closed off before turning air pump on BUT MAKE SURE the **cross filling tube valve is OPEN** so that the air from the canopy can purge/travel through to the air beams on to help.



**External Inflating /
Deflating Air Valve**



**To OPEN valve turn counter clockwise.
To CLOSE valve turn clockwise until firm.**

Tip 9 - Remember to turn the MAIN INFLATION valve in the camper to the horizontal CLOSED position when inflation is complete otherwise the canopy may slowly deflate over time.

Tip 10 - If the beams are losing air slightly you can turn the inbuilt air pump ON and that will top up the air pressure in all air beams back to the desired pressure, the pump will turn OFF automatically.

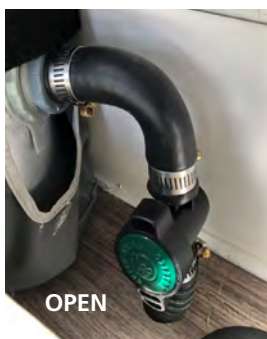
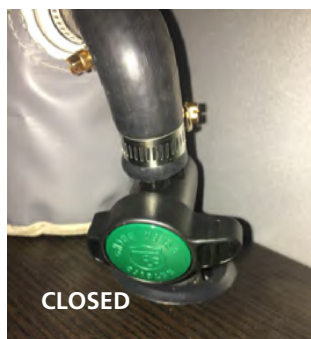

IMPORTANT

**Remember to open the
main valve while inflating.**

Tip 11 - Before you set off on your first trip, do a couple of full set ups and while you have all the canopy and annexe up, remember to weather-in the canvas and allow to dry completely before packing up!

HITCHING & TRAILER ELECTRICS

About your Coupling

The Air OPUS® comes with a polyblock off-road coupling.

When hitching the Air OPUS® to your towing vehicle you must ensure that someone is close to the handbrake in order to maintain control of the trailer, particularly when manoeuvring on uneven ground or a slope.



About your Electrical Plugs

7 PIN FLAT PLUG

The Air OPUS® is fitted with a 7-pin flat plug that connects all the exterior trailer lighting and the electric brakes to the towing vehicle. A standard 7 pin plug is required on your tow vehicle for this to connect to.

ANDERSON PLUG

The Air OPUS® is also fitted with a 50 amp Anderson Plug which is connected to the Air OPUS® batteries. If you have a compatible Anderson plug on your towing vehicle you can use this to charge your OPUS batteries whilst in transit.

Disconnect these plugs when the engine of the towing vehicle is not running, as it will continue to draw current **and you may end up with a flat battery on your towing vehicle.**

You can also use this Anderson plug to attach a solar panel which will also charge your Air OPUS® batteries. The solar panel must have a built in regulator.

The Anderson Plug runs through its own resetable fused system located in the battery compartment.

IMPORTANT

Wheel nuts should be checked after first 100km and then every 1000km.

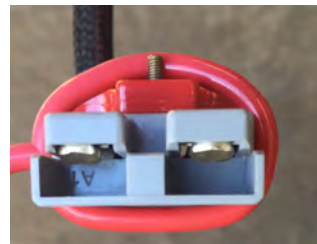

Air OPUS® BRAKE SET UP

About your Brakes

The Air OPUS® is fitted with electric trailer brakes. You need an electric brake controller fitted to your car in order to tow the Air OPUS® and operate the electric brakes safely. Before departing, place car in drive and check that the Air OPUS® brakes are on. Refer to brake controller user manual for correct adjustment.

BREAK-AWAY SWITCH

Your camper comes with a break-away switch. This is a safety device which will apply the trailer brakes if it becomes disconnected from the tow vehicle.

MAINTENANCE

As part of the annual service check you should have completed by an accredited industry service agent, the brakes should be checked and maintained.



IMPORTANT

The break-away switch is not a security device! When cable is pulled, switch will drain power from batteries



SETTING UP YOUR Air OPUS® CAMPER

Initial Steps

STEP 1 - Once you have positioned & leveled your Air OPUS® on flat ground (leveling wedges may be required - not supplied), engage the handbrake & disconnect hitch, wiring & chains from tow vehicle.

STEP 2 - Raise or lower the jockey wheel to level your Air OPUS® lengthways.

STEP 3 - Using the leg winder supplied, gently lower corner steady legs until each touches the ground with enough pressure to stop any rocking.

STEP 4 - If you have a drop down spare wheel set up, please adhere to these safety requirements. Unclip the spare wheel carrier and lower it down gently to the horizontal position, taking care to support the weight of the spare wheel carrier so that it does not swing free and fall.

IMPORTANT

Corner support legs are only to support the Air OPUS® NOT to be used to level or lift.

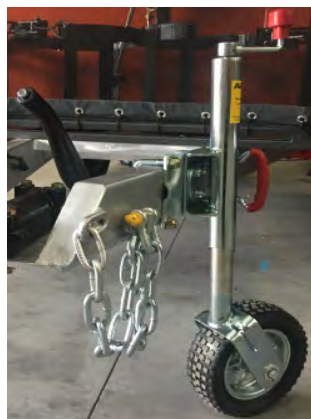

STEP 5 - If roof rack is fitted, remove D Clips and unlatch the 2 retaining clips. Once rack is free push up until the gas struts take the weight. From the other side of the camper pull roof rack into vertical position and secure upright with D clips through mounting point.

SETTING UP YOUR Air OPUS® CAMPER

Initial Steps

STEP 6 - Unlatch the lid starting at the rear of the camper. Lift the lid 20cm.

STEP 7 - Unwind the front winch until the strap is long enough to reach the back of the camper. Clamp the winch onto the rear eyelet mounted on the back of the lid. Unwind the rear supporting winch and clip on with enough slack to allow the lid to rise to vertical.



IMPORTANT Take care not to stand underneath the lid as it comes down. Ensure lid is lowered slowly & does not drop suddenly.

STEP 8 - Ensuring that the strap remains flat and tensioned, slowly wind the winch in to bring the lid up and over the camper. The gas struts will take the weight of the lid.

STEP 9 - Once lid is fully open and resting against stone guard secure in place using latch provided

STEP 10 - At this stage walk around the Air OPUS® and inspect the tent to ensure that the canvas is properly located within the aluminium channels and that no part of the tent is caught or snagged.

STEP 11 - At front of camper fit each corner of the canvas over the corner of the lid. The seam on the canvas should line up with each corner of the bed lid. Secure using straps provided.

STEP 12

Ensure the main internal air valve is open (vertical/inline). Tighten all external air valves on each air beam (5 on tent and 7 on annexe).

STEP 13

Turn the power key ON. Turn the pump master switch ON. Push the pump button and watch your camper inflate!

STEP 14

CLOSE the main internal valve to lock off air system. You may also wish to close your cross linking valves to retain constant pressure over an extended stay.



REPEAT STEPS 1-12 IN REVERSE TO PACK AWAY. REMEMBER TO ZIP UP YOUR DOORS AND WINDOWS & OPEN MAIN VALVE BEFORE DEFLATING CAMPER.

UNDERSTANDING THE Air OPUS® SWITCHBOARD

Main features of your switchboard

- | | |
|--------------------------|-------------------------------|
| 1 Main Power Key Switch | 8 Air Pump Master Switch |
| 2 Front Pump | 9 Air Inflation Button |
| 3 Rear Pump | 10 Battery Level Indicator |
| 4 Fridge Master Switch | 11 Volt/amp Gauge |
| 5 Lighting Master Switch | 12 12V Circuit Breaker Reset |
| 6 Front Tank Indicator | 13 12V Master Circuit Breaker |
| 7 Rear Tank Indicator | 14 12V Power Outlet |

240v Circuit Breaker

Located inside the camper

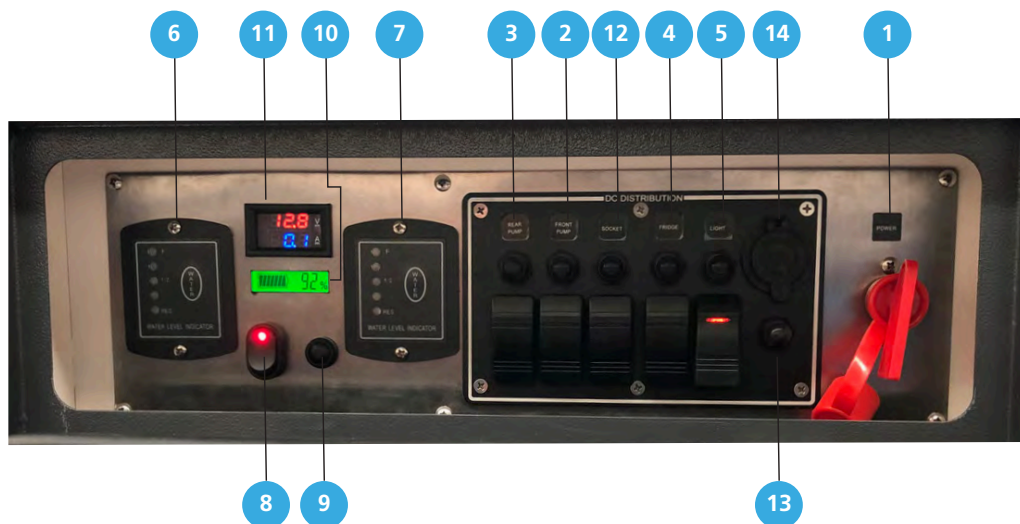

Quick steps to turn Air pump on for inflation

- Step 1** - Turn main power key switch ON
Step 2 - Turn air pump master switch ON
Step 3 - PRESS air inflation button ON and release, then pump will turn off automatically once at desired pressure.

Quick steps to check battery level

- Step 1** - Turn on main power switch
Step 2 - Look at digital volt gauge
Step 3 - Look at battery level indicator

IMPORTANT

Your main inflation valve must be open/in line for your pump to run. DO NOT hold the button in if it shuts off when pressed or you will risk damaging your pump.

UNDERSTANDING THE AIR VALVES WHEN SETTING UP YOUR Air OPUS® CAMPER

1 Check all 5 outside valves are closed.

Tube/
Retaining Ring Air Valve /
Deflation Valve Valve Cap



3 Open switch board, turn on main 12v power key, switch main air pump switch to on, press inflation button.



4 Once inflation is complete turn the Main Inflation valve switch (inside camper) to a Horizontal CLOSED position by rotating clockwise.

IMPORTANT

Failure to CLOSE the Main inflation valve switch after inflation will cause the Annexe and Canopy to slowly deflate.

2 When inflating turn the Main Inflation valve switch (inside camper) to a Vertical OPEN position by rotating anticlockwise.

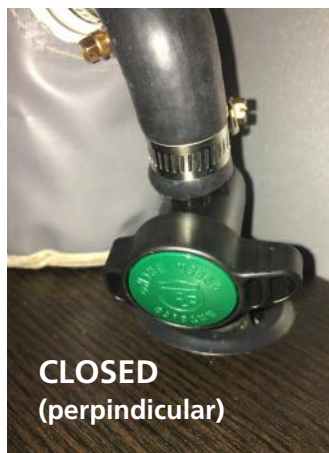

Water System Set up

The Air OPUS® is fitted with two fresh water tanks, with one unit mounted in front of the axle and the other unit mounted behind the axle. Each water tank has its own lockable fill point located on the driver side of the body of the Air OPUS® and is plumbed to a 12v switchable water pump located on the circuit board. Each tank has its own pump, each tank is stand alone.

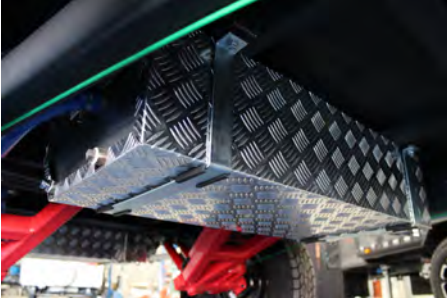

One tank supplies water to the driver's shower side outlet behind the wheels and the shower also located in this area. There is also the capability to connect mains water to your inlet but you will require an external water regulator to avoid damaging your system. The other tank supplies water to the slide out kitchen. There is also a water outlet located next to the tank outlet connector.

The water fitting closest to the rear of the camper on either side is your tank outlet. The water fitting closest to the front of the camper on either side is your inlet/cross filling tube.

Remove the red dust cap from the fitting before activating the pump to ensure the fitting is not engaged and your water doesn't pump out.

To use an opposing tank, simply plumb the inlet and outlet together on the side you wish to plumb from and run the pump for the tank corresponding to that side. Then, connect the blue hose on the opposing side you require water at to the outlet closest to the front of the camper.



Air OPUS® WATER SYSTEM

The kitchen sink is connected with a short hose with fitting attached, this is to be plugged into the water outlet connection on the Air OPUS® and the water intake on the kitchen, which is only accessible when the kitchen is fully extended.

The kitchen has a drain hose attached to the sink drain. This is designed to drain cold water to a waste container/bucket as the Air OPUS® is a cold water unit.

The water pumps are pressure operated, so once the main 12 Volt power switch is turned on at the circuit board, the pump will prime the system and as soon as you turn the tap on the water will flow. Once the tap is closed the pump will turn off until the tap is turned back on.

When the water system is not required Air OPUS® recommends to switch off the pump when not in use.

When packing away the Air OPUS® follow the procedure below in order to drain the system of any excess water before disconnecting the water inlet and internal waste pipe:

- A. **Switch off the pump at the mains power switch.**
- B. **Open the tap & allow the excess water in the pipe to drain.**
- C. **Close the tap once all of the water has drained.**
- D. **Disconnect either side of the male-to-male hose coupler.**
- E. **Place the bottom waste water outlet pipe away under sink.**

IMPORTANT

A SMALL AMOUNT OF WATER MAY BE PRESENT FROM THE CONNECTORS AND WASTE HOSE, SO A CLOTH IS USEFUL TO REMOVE ANY EXCESS WATER.



Draining your Tanks prior to storage

DO NOT use your pumps to drain your tanks - running the pumps until the tank is dry will damage your pumps and will not be covered by warranty. Use the drain point/sump plug on the underside of the tank. For further storage information refer to the STORING YOUR OPUS section in this handbook.

Air OPUS® GAS SYSTEM

Safe operating procedures for your gas system

PLEASE refer to the information located on the rear of your OPUS® gas certificate.

IMPORTANT

CHECK THE INSTRUCTIONS FOR CORRECT FITMENT AND SAFE USE WITH THE GAS CYLINDER MANUFACTURER/SUPPLIER.

STEP 1. The Air OPUS® is fitted with rings for two 9kg gas bottles. One bottle at a time can be connected via the gas regulator provided and must be turned off when the gas is not in use.

STEP 2. To install a gas cylinder, ensure the gas cylinder is placed correctly with J-clamp, attach the threaded gas line to the bottle ensuring that's its been tightened so no leaks occur. It is advisable to keep an adjustable spanner with jaw opening up to 30mm for this use.

STEP 3. Once kitchen has been pulled out all the way you can fit the gas bayonet hose to the bayonet. This is a simple push and twist to install.

STEP 4. The gas tap/valve on the top of the gas bottle can now be opened. Allow 5 minutes for gas to plumb through.

STEP 5. Turn on the yellow gas tap (situated underneath the rear of the OPUS behind each of the gas outlets unit) by turning 90° until it's in -line with the gas hose.

STEP 6. Lift up lid of the gas hob, turn on one of the burners (push in, hold the knob down until flame is lit and stays on. Keep pressing the button until the gas has had time to fill up the system and the burner will ignite.

STEP 7. Switch off the yellow gas valve when not in use and ensure that the gas bottle valve is closed prior to packing up the Air OPUS® for transit or storage.

When Annexe is being used, ensure sure both ventilation points are clear and not covered, one on the drop skirt and the other on the roof of the rear pod. Leave the privacy screen behind your kitchen OPEN.

Gas fumes inside a camper trailer tent could result in unconsciousness, brain damage or even death. Follow safe operating procedures with gas at all times:

- **Ensure good ventilation throughout, at ALL times**
- **Do not use any other gas systems than those provided with the Air OPUS® camper inside the tent**
- **Always turn off the shut off valve IMMEDIATELY after use.**

TIP - If your igniter on your stove is not clicking, check your D battery hasn't dislodged. You can do this by removing your cutlery drawer, and the D battery is tucked under the front of the stove top beneath the bottom right burner. This battery may lose contact or become dislodged during transit.

Air OPUS® 240 VOLT MAINS POWER

240V - Safe operating procedures

The Air OPUS® comes fitted with a 240 volt power system. This 240 volt power system complies with Australian Safety Standard AS3001.

The main circuit breaker and RCD is located either inside the camper or at your main switch panel depending on your model. The main 15Amp power input is found on the driver's side of the Air OPUS®.

There are two 10A internal 240V power points and one external.

In the storage area behind the stereo is the first 240V outlet and the second outlet is located in the front D/S storage.

The external power point is located on the passenger side of the Air OPUS® in front of the wheel arch. Regular battery maintenance checks (charge every 2-3 weeks) will prolong the life of your batteries as AGM/Deep Cycle Batteries do not rejuvenate well from flat.

Air OPUS® 12 VOLT POWER

12 Volt - Safe operating procedures

The Air OPUS® has many 12V outlets - they are a combination of standard 12V sockets, 12V light sockets, USB sockets and switches. These are located throughout your camper trailer both internally and externally.

Next to the main door you will find your stereo system, light switch and dimmers for internal and external fixed body lighting. The dimmers will only operate the build-in lighting and will not influence any other lighting you run via sockets.

The control panel has a battery volt-meter that will provide an indication of the remaining charge of the batteries and amp draw display in real time. A full battery will be indicated by the Battery Level Indicator.

There are also two water tank gauges which will display the water level when pressed.

All switches have their own resettable fuse next to each of the switches in addition to a master resettable circuit breaker for the whole 12V system located next to these controls. Your batteries are also fused - in the battery compartment the large resettable fuse is wired to the 50amp Anderson plug fitted at the drawbar.

All sockets, fridge power and lighting will operate on 12V power from the on board batteries; heavy usage and power hungry appliances will deplete the battery's charge. It is recommended to have the mains 240V connected to a suitable supply if available, even if appliances are run on 12V only, to ensure your batteries remain topped up.

The battery charger is fully automatic and will recharge the batteries if the Air OPUS® is connected to an 240V electric power supply via the 15amp power inlet.

Do not unplug or disconnect this charger internally as it may lose memory settings for your battery set up and affect your charging. This is an automatic cycle charger and if using, allow enough time for the charger to complete a full charge cycle.

Regular battery maintenance checks (charge once a month) will prolong the life of your battery as AGM/Deep Cycle Batteries do not like to be drained flat.

Refer to your battery charger instruction manual for further details.

TOWING WIRING

The trailer lights and electric brakes are wired to a standard 7 pin trailer plug.

The Air OPUS® is fitted with electric brakes. While in transit if the tow vehicle has the Anderson Plug connected this will also be topping up the batteries.

IMPORTANT

Your towing vehicle must have an in-car electric brake controller installed or your warranty will be voided.

Air OPUS® FRIDGE SLIDE

Your Air OPUS® is supplied with a powered fridge slide to mount your 12V travel fridge.

LIGHT

The fridge drawer has a sensor-activated light inside for ease of use at night time. This light will only run if the "Light" master switch on your panel is on. The sensor must be activated by a change from light to dark to detect and switch on.

POWER

A 12V socket is supplied at the side of the fridge slide to run your fridge. This outlet is run off the "Fridge" master switch on your switch panel.

IMPORTANT Be careful not to catch or crush your fridge's power cable in the slide mechanism

FAN

Your opening door is also fitted with a small fan. The switch for this fan is located next to the 12V fridge socket. You do not have to run this fan, however it is recommended for hot days and long trips to prevent overheating your fridge. The fan is powered by the "Light" switch circuit

TIP - If you wish to travel with your fridge powered and fan running, you must leave the red power key in and switched on, and the LIGHT and FRIDGE switches activated.

SETTING UP THE ADDITIONAL DAY BED

Seating moved to create additional bed

The seating area inside the Air OPUS® can be reconfigured as shown.

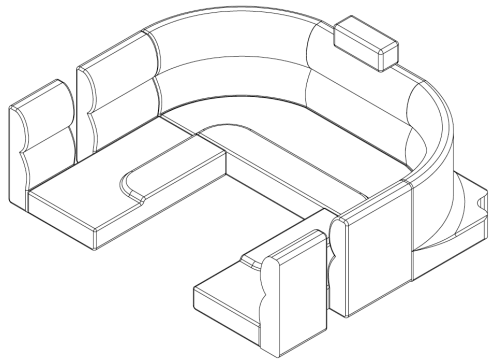
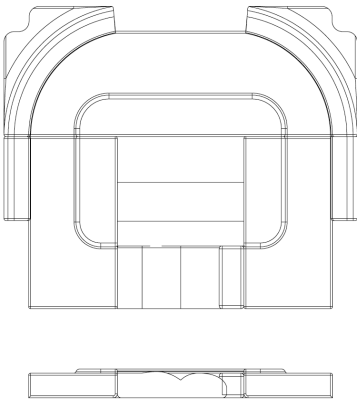
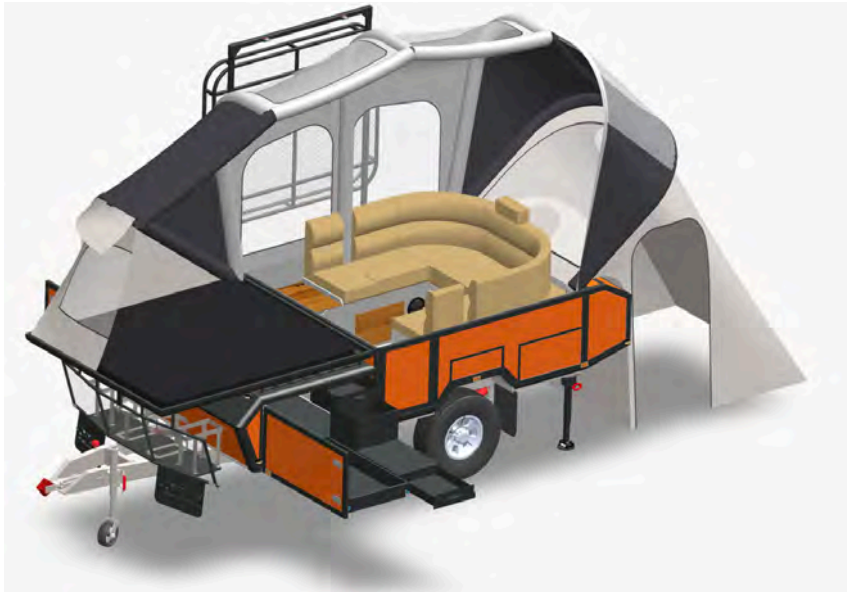

INSTALLING YOUR Air OPUS® ANNEXE

Attaching annexe to canopy

Step 1 - To attach the annexe to the canopy of the camper deflate the canopy to attain easy access to zip area (**see picture as shown**).



Step 2A - Zip on annexe roof as shown, attach left and right buckles at either bed end and velcro down straps.

Then connect left and right corners of the annexe to the corners of the OPUS camper.



Step 2B -

Connect roof air inflation point to the Opus tent.



INSTALLING YOUR Air OPUS® ANNEXE

Step 3 - Spread annexe canvas out from the camper as shown



Inflating the annexe when attached to canopy

Step 4 - Make sure the 5 valves on the Opus camper tent are closed and inflate the main tent whilst the annexe attached.



Step 5 - Before inflating the annexe make sure all 7 outer valves on the annexe are closed.

Step 6 - With the cross connecting tube attached, you can open both valves, one from tent and the other on annexe. This will then start to fill the annexe turn air pump on and it will automatically turn off.

Step 7 - Turn inbuilt pump on to start annexe inflation. Keep an eye out for obstructions and when the annexe starting to form, feel free to help guide the air beams to assist in easy flow of the air through them and form final annexe structure.



INSTALLING YOUR Air OPUS® ANNEXE

Inflating the annexe when attached to canopy continued...

Step 8 - After main pump shuts off it has reached the desired pressure. Remember to turn the main inflation valve in the camper to the horizontal CLOSED position when inflation is complete. If planning a long stay, close cross linking tubes on annexe and tent to retain pressure, including the cross filling tube. Remember to reopen prior to Deflation!

Step 9 - Using the black straps provided set the feet of the annexe at 2.4M out from the side of the camper and tension. Ensure all feet are sitting on their protective canvas bases. Peg feet into ground if weather suggests.

Step 10 - Attach all velcro seals between canopy and annexe to shut out wind and seal room. Zip draft skirt into zipper along side of camper.



INSTALLING YOUR Air OPUS® ENSUITE



Fitting the Ensuite Room

1. Using the toggle provided, zip the ensuite top onto the end air beam over your spare wheel.
2. Peg down each corner/base to tension the room.
3. You may also wish to use the guide ropes provided to retain the shape of the room.

IMPORTANT

Remove the ensuite every pack down to prevent any moisture being trapped inside the camper.

Air OPUS® CARE AND MAINTENANCE

Changing a faulty bladder when product is not inflated/in use

Step 1. Locate the faulty air beam and check that all valves are closed on the beam.

Step 2. Remove linking air tube from faulty beam.

Step 3. Unzip the outer retaining sleeve to reveal the grey beam tube.

Step 4. Undo the ties holding the zips on the grey tube together and unfasten the zip.

While unzipping or zipping be careful NOT to allow the zipper to pinch the air tube.

Step 5. Remove the bladder from the structural tube as shown. Reinflate the bladder and locate the puncture. Using the repair kit provided, patch the hole and let dry. Test the puncture is sealed by reinflating using the hand pump supplied.

DO NOT OVER INFLATE. If the bladder can not be repaired please contact the dealer.



Step 6. Once successfully repaired, reverse above steps.



IMPORTANT

DO NOT CHANGE OR UNZIP BLADDERS WHEN CAMPER IS INFLATED. ISOLATE BEAM & DEFLATE BEFORE BEGINNING

Step 7. Reattach the crosslinking tie to the repaired beam. This is a firm fit - ensure it is pushed on ALL the way and sitting flush before reopening valve.

Step 8. Reopen the crosslinking valves to allow air to equalise. To repressurise the camper, open your main valve and reactivate pump - this will shut off again once the cabin reaches pressure. Relock your crosslinking valves again once done to retain pressure.



IMPORTANT

Ensure zip doesn't pinch bladder! Zip beam back in straight and aligned to the holes in the tube. If a replacement air beam is fitted and the length exceeds the

Air OPUS® CARE AND MAINTENANCE

IMPORTANT THE OPUS® CAMPER MUST NOT BE STORED WET/DAMP

Storage

Pack down the camper correctly as per procedure outlined.

Make sure that you pack down your Air OPUS® tent and annexe when the canvas is **completely dry BEFORE being stored**. If taken down wet, dry completely at the first opportunity to avoid damage to the tent or annexe - this **MUST** be done within the next 24 hours.

It is strongly advised that you purchase a storage cover for your Air OPUS® if it is to be stored in an uncovered location. A storage cover is advised if your camper is left exposed to the elements.

Clean off dirt, tree sap, bird & bad droppings and grime on the unit from travelling/terrain to keep your camper in good condition and maximise its longevity. Failure to do this may permanently mark or stain your composite panelling.

Regular battery maintenance checks (charge once a month) will prolong the life of your battery as AGM/Deep Cycle Batteries do not like to be drained flat. Empty the water tanks prior to storing. Ensure this is done from drain points and not by running the pump.

Return to the Road

Ensure that your camper and accessories are fit for the road and you adhere to all local laws.

Check the wheels and tyres and ensure they are in good condition with the wheel nuts correctly torqued (125NM).

Check the tyre pressure before driving (50PSI when cold).

Check that polyblock coupling (receiving hitch) is tight.

Check the lights and fittings and ensure they are functioning correctly.

The chassis/running gear and the gas installation of your OPUS® camper should be checked on an annual basis by a qualified service centre.

Air OPUS® CARE AND MAINTENANCE

Caring for your Canvas

In order for the Air OPUS® to give you years of camping pleasure, the tent and annexe need to be cared for and **MUST NOT** be left wet/damp when packed away. If it is unavoidable that you will have to pack down your Air OPUS® when the canvas is wet, it is very important that the Air OPUS® tent, annexe and ensuite room are dried in the sun as soon as possible - this should be done within 24 hours.

All Air OPUS® tents and annexes must be “weathered” before use. To do this you will need to thoroughly saturate the canvas by hosing it down with water and then allow it to dry prior to its first use. It is possible, due to the nature of the canvas that there may be a small amount of water ingress during the first few uses in wet weather; this is normal as the tent and the annexe go through ‘weathering’ or ‘conditioning’. If this persists, please notify us as soon as possible.

Maintenance Tips

- Allow condensation to clear and dry before packing/storing the camper.
- Regularly check the seams of the tent and annexe and if required apply seam sealer or suitable alternative. Follow the product instructions and allow to fully dry before packing.
- Regularly check the velcro straps and seams
- Never force the zips of the tent or annexe to open or close; inspect for any issues and rectify as necessary.
- Ensure the zips are used and cared for properly, if needed a zip lubricant can be used to allow for smooth operation.
- Regularly inspect the tent and annexe for holes, rips/tears and damages and have a suitable tent repair kit for use in emergencies.
- Ensure doors and windows are closed before deflation and reinflation
- Ensure your main inflation valve and all cross linking valves are OPEN before packing away
- Take care when setting up and packing down the camper to ensure the tent, and the annexe beading is not caught or snagged, should this occur retrace the steps and retry making sure the issue is rectified.
- Should a rip/tear occur assess the damage before taking action. If unsure contact your OPUS Camper dealer. Small rips/tears can be repaired using the appropriate repair kit and procedure and may not require a professional or return to the dealer or us for repair; should the damage be significant or exceed your capacity, please contact your OPUS dealer or us.

Air OPUS® CARE AND MAINTENANCE

External Care for your Air Opus®

- Inspect the outside panels of your Air OPUS® including the roof (bed lids) for any damage or cracks.
- Inspect the sealant around the panels to verify that there is adequate bonding around the body panels and exterior features such as the front storage box/fridge cabinet. This is especially important after an impact/accident to the camper to ensure the integrity of the body's resistance to water ingress.
- Regularly check the seals (centre and perimeter) of the camper, to ensure there has been no damage. Ensure your Air OPUS® is packed properly to seal the camper and prevent water ingress.
- Keep the body and the roof of the camper clean, it is best to clean any mud and dirt off the camper immediately or after every journey to maintain its clean finish.
- Prolonged exposure to UV, mud, dirt and salt may deteriorate the finish of the camper.
- The body of the camper can be washed with soap and water using a soft sponge. Rinse the camper thoroughly after washing.
- A damp cloth may be preferred especially for small spots and dirt.
- Specialist products such as Care-avan Waterless Wash & Shine may be used where/when adequate water is not readily available. Read and follow the instructions carefully and it is advisable to try any product to be used on the camper on a small inconspicuous spot to ensure/verify it is suitable before full use.
- Any form of damage or scratch to the paint work or finish of the camper on the body may be repaired or cleaned by using a suitable 'touch up' stick/paint.

Contact your dealer or Air OPUS® camper directly for further information.

Condensation

Condensation needs to be considered in both the Air OPUS® camper tent and the annexe.

Condensation is caused by warm, moist air coming into contact with cold surfaces. This can occur inside most tents and annexes, which may sometimes be misinterpreted as the fabric leaking.

There is always moisture in the air when you pitch a waterproof fabric above damp ground; however the situation is made worse by adding people who are breathing out warm water vapour. When the warm moist air inside comes into contact with the fabric of the Air OPUS® camper tent or the annexe material, which is cooled by the outside air, condensation forms.

While the Air OPUS® is stored away condensation may occur we highly recommend you open the Air OPUS® on a monthly basis for long term care of the canvas.

During rain more condensation can form due to lower outside temperature and drops can form and run down seams or fall on internal poles, giving the appearance of a leak.

There are a few main causes of condensation:

- Ground moisture rising inside your annexe.
- Your breath - when sleeping at night you will exhale approximately 1 litre of water. This water vapour is trapped within your OPUS® or annexe - this will escape through opening windows, doors or vents.
- Storing damp or wet accessories e.g. floor mats, chairs, clothes etc.
- Cooking by gas - 0.5 hours of cooking can produce 0.5 litres of water.

It is natural for the body to perspire (sweat) during the night; please ensure the camper is WELL VENTILATED to avoid excessive condensation which could result in issues such as mould or damp if adequate care is not taken.

After a night's sleep please INSPECT the mattress to ensure no condensation is present and the mattress is properly aired.

If in storage for a long period of time such as 4 weeks or longer, its recommended to open and let it breathe for 24 hours. If the Air OPUS® is based in tropical warm areas eg. NSW, QLD, NT etc. will cause condensation when closed & may need to be opened & aired more regularly.

Air OPUS® CARE AND MAINTENANCE

Ventilation

Ventilation is more important than is generally realised - your Air OPUS® camper and annexe have several windows/vents that can be opened to help increase air ventilation. An increase in ventilation will result in a decrease of condensation. Under extreme conditions, condensation cannot be completely avoided.

Condensation nearly always occurs on the roof poles and therefore it is often confused with leaks.

Leave the ventilation panels open as much as possible. To prevent ground moisture rising inside the awning, a plastic underlay can be placed underneath, but this will cause the grass to die and may contravene some caravan/camp site rules.

When cooking in the Air OPUS® Annexe it is crucial to ensure the ventilation vents located above and below kitchen slide out are clear and not covered.



IMPORTANT
WHEN COOKING DO NOT
HAVE THE ROOM DIVIDER
CLOSED BEHIND KITCHEN
SLIDE OUT. IT MUST BE OPEN.

WARNING This vent must remain permanently open, clean and unrestricted to provide ventilation when gas appliances are in use.



Thank you from...

OPUS
CAMPER & ANNEXES



**WARNING: UNZIP BOTH DOOR SECTIONS
WHEN VENT OR FLUE IS LOCATED INSIDE ANNEXE.**

FAILURE TO DO SO MAY RESULT IN DEATH

This will ensure ventilation for gas & carbon monoxide required
by Australian/New Zealand Standard: AS/NZS5601.2:2013



Introduction

The following information relates to warranties offered by OPUS. Please read all the information carefully, and should you have any questions relating to any aspect of this section, please contact OPUS. By purchasing an item from OPUS, you hereby agree to all terms and conditions of warranty as set out herein.

OPUS will always deal with warranty claims reasonably and in good faith. We offer a 12 month warranty on all fittings and fixtures, plus the following specific warranties:

5 Year Suspension Warranty
3 Year Canvas & Tent Warranty
5 Year Structural Warranty



OPUS warranties apply for the use of your OPUS on any road or track that is trafficable to normal four-wheel-drive vehicles.

Validity of Claims

- Warranties are valid to the original purchaser of the item in question and apply from the original date of purchase.
- Warranties apply to items sold as "new" and do not extend to items sold via auction, or deemed to be "factory seconds", "ex-demonstration" or "damaged" unless specifically stated otherwise by OPUS in writing. (See details later in this document.)
- Warranties are not transferable. Also, if the original purchaser sells an item to a third party, the original purchaser cannot make any claims on behalf of the new owner.
- Warranties do not apply to products used in hire schemes or as rentals.
- OPUS does not cover damage due to unauthorised modifications, misuse, abuse, incorrect assembly, improper and irregular maintenance, or accident or collision.
- Any work performed under an authorised warranty claim approved by OPUS must be performed by OPUS, or an authorised representative of OPUS, and only with the express written permission of OPUS.
- Affiliates, representatives, associates, agents, suppliers, resellers or similar of OPUS shall have no authority to authorise or deny warranty claims on behalf of OPUS.

Air OPUS® WARRANTY

- OPUS shall not be liable (in part or whole) for any warranties, either express or implied, made by agents or resellers on behalf of OPUS without the knowledge or express written permission of OPUS. Such unauthorised claims shall be the responsibility of the agent or reseller only.

Our goods come with guarantees that cannot be excluded under the Australian Consumer Law. You are entitled to a replacement or refund for a major failure and for compensation for any other reasonably foreseeable loss or damage. You are also entitled to have the goods repaired or replaced if the goods fail to be of acceptable quality and the failure does not amount to a major failure.

OPUS Campers are designed for use on any road or track that is trafficable to normal four-wheel-drive vehicles.

OPUS Campers can be exposed to water crossings where the water is below body floor level, but never where the water is at, or above, body floor level.

The following items are not covered under the OPUS warranty:

- Impact or stone damage to body, chassis or running gear.
- Soiling of fabrics and internal fitments from dust and other airborne substances.
- Water damage due to water crossings.
- Movement or damage caused by dislodgment of appliances and fittings resulting from hard impact or heavy landings or severely rutted roads or tracks.
- General damage arising from misuse.
- Rust
- Wheels and Tyres
- Paint
- Faults to canvas when stored wet.
- General consumables such as bearings, light fittings, batteries etc.
- Wear and tear when the trailer is used for permanent living purposes

OPUS includes equipment and fittings, such as audio equipment and pumps, which are warranted separately by their manufacturer and not covered by the OPUS Warranty. If necessary, OPUS will help an owner make a warranty claim to these manufacturers.

In addition to the express OPUS warranty, the consumer may also be covered by other rights and remedies of the Australian Consumer Law in relation to the goods and or services to which this warranty relates.

Tents

Tents are guaranteed to be in new merchantable condition at the time of purchase. A limited manufacturer's warranty period of 3 Years applies to OPUS canvas components, poles and fittings, air beams and valves. General wear and tear excepted. Zips and mesh or screens are not covered.

Factory Seconds, Ex-Demonstration & Damaged Goods

From time to time, OPUS may offer for sale items deemed to be "factory seconds", "ex-demonstration", or "damaged". Any such items are sold on an "as is" basis.

There are no warranties, refunds, credits, exchanges or similar associated with such items. In the sale of such items, OPUS will attempt to provide all relevant information regarding the item, including faults, defects, or similar, however, there may be instances where minor defects or imperfections have been overlooked. This is purely unintentional and in no way alters the nature of the sale.

Due to the nature of such items, being "ex-demonstration", "factory seconds" or "damaged", it is reasonable to expect that some imperfections or flaws may exist even where it is not initially apparent. By purchasing such an item, you agree to this statement and accept that there are no warranties implied or expressed

Lodging a Claim

All warranty claims should be lodged by contacting your dealer directly.

Contact

If you have any further questions relating to warranties, or are unsure about any aspect of this section, please contact OPUS.

Phone: (03) 9588 2959

Email: enquiries@opuscamper.com.au

PCT Patent Pending GB/2017/050391 &
Australian Patent Pending 2017902549
Design registration No 201712810,
No 201712811, No 201712812, No

For further information please
contact the Air OPUS® team

03 9588 2959

enquiries@opuscamper.com.au

Find us on Facebook & Instagram



OPUS®
opuscamper.com.au

Photographs and diagrams are for illustration purposes only. Actual product may vary
and any specifications are subject to change without prior notice.
All information correct at time of print. © Purple Line Pty Ltd 2019.
Issue No: 05042019